

Parts for Pump Models: SP2910, SP2915, SP2910ET, SP2915ET

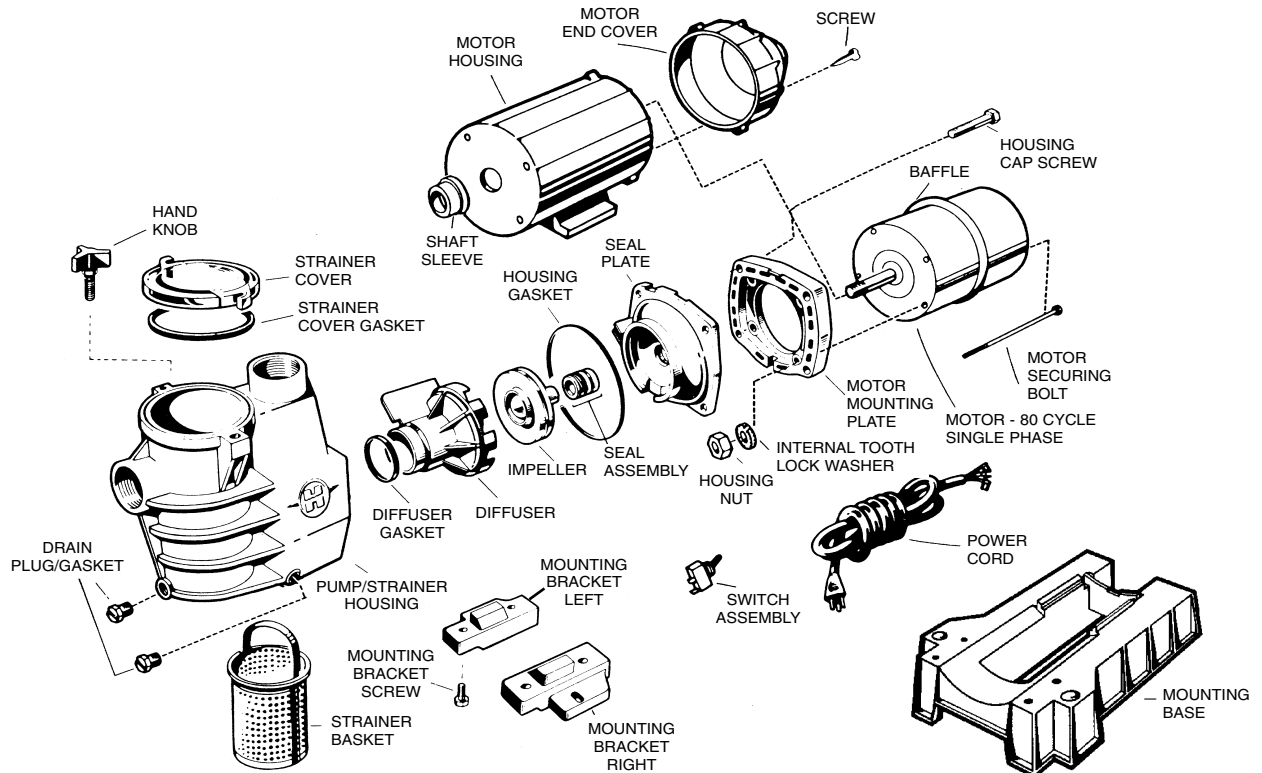

Part No.	Description	Ctn. Qty.
SPX1250LA	Strainer Cover	10
SPX0125T	Strainer Cover Gasket	10
SPX1250Z4	Hand Knob	10
SPX1700FG	Drain Plug/Gasket	10
SPX2800AA	Pump/Strainer Housing	1
SPX1600R	Diffuser Gasket	25
SPX2800B	Diffuser	1
SPX2915CT	Impeller	10
SPX1600Z2	Seal Assembly	10
SPX1600T	Housing Gasket	10
SPX2600E	Seal Plate	1
SPX1600F3M	Motor Mounting Plate	1
SPX2800M	Strainer Basket	10
SPX1600Z4	Housing Cap Screw	10
SPX2000A3	Motor Housing	10
SPX1500Q4	Shaft Sleeve	10
SPX1510N9	Housing Nut	10
SPX3300Z1	Internal Tooth Lock Washer	25
SPX2000E	Baffle	1
SPX1600Z5	Mounting Bracket Screw	25
SPX1600K	Mounting Bracket Left (prior to 2000)	1
SPX1600L	Mounting Bracket Right (prior to 2000)	1
ECX1325R	Switch Assembly	5
ECX13252R	Switch Assembly - 2speed	
SPX1550WA6C	Power Cord	5
SPX1510N7	Motor Securing Bolt	25
SPX2000C2	Motor End Cover	1
SPX1411Z3	Screw	25
SPX2601C	Base	1